

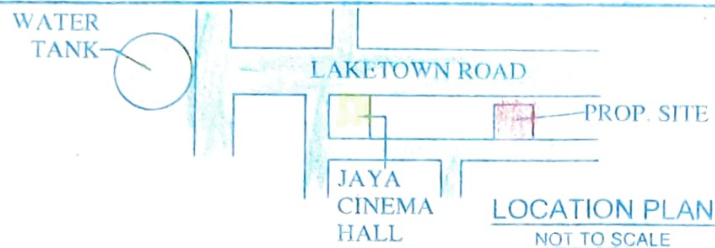

Long: 22.60550
Lati: 88.40283



SITE PLAN OF A LAND WITH EXT. - II STD. OF SRI SHRIDHAR PATHAK & OTHERS IN RESPECT OF HOLDING NO. - 1131, LAKE TOWN, WARD NO. - 30, MOUZA - PATIPUKUR, J. L. NO. - 24, C.S. DAG NO - 425 & 412, PLOT NO. - 727 & 728, L.R. DAG NO. - 973, 643, R.S. DAG NO - 412, P. S. - LAKE TOWN, DIST. - 24 PARGANAS(N), UNDER SOUTH DUM DUM MUNICIPALITY.

NATURE OF LAND - NOT AVAILABLE

AREA STATEMENT

- TOTAL AREA OF LAND (AS PER DEED) - 05K - 00 CH - 00 SFT. = 334.45 Sqm
- TOTAL AREA OF LAND (AS PER PHYSICAL) ----- 334.04 Sqm
- PERMISSIBLE COV. AREA (58.30%) ----- 194.74 Sqm.

SITE PLAN FOR PROPOSED BLDG. PLAN AS PER RULES.

I DO HEREBY DECLARE THAT THERE IS NO COURT CASE OR ANY COMPLAIN FROM ANY CORNER OF MY PROPERTY AS PER PLAN. I ALSO DECLARE THAT I HAVE NOT SOLD ANY PORTION OF PROPERTY SHOWN IN PLAN TO ANYBODY UPTILL NOW. IF ANY PROBLEM ARISES IN FUTURE THEN THE SOUTH DUMDUM MUNICIPALITY WILL NOT BE LIABLE FOR THAT.

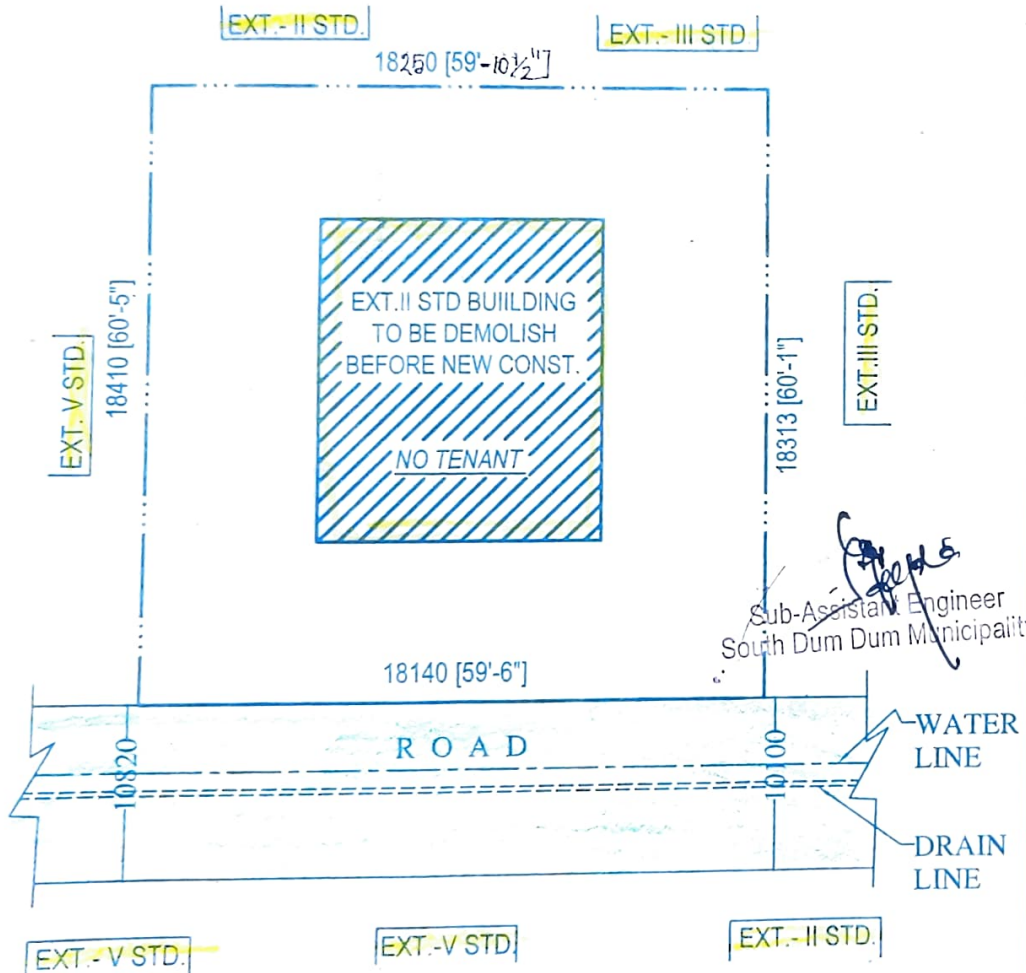

Sub-Assistant Engineer
South Dum Dum Municipality

RAMSISARIA REALTORS PRIVATE LIMITED

Ashwin Tekwal

Director

SIGNATURE OF OWNER

SCALE -1:200



Abhjit Kumar Pal
ABHJIT KUMAR PAL
Licensed Building Surveyor
Class - II Lic No - SDOM/ L.B.S/24

SIGNATURE OF L. B. S.

SITE PLAN

(SCALE -1:200)